



ELS-X24 Heavy Duty P-6036 Telemetry Load Shackle

Euroload Limited provide a range of Heavy Duty Hazardous area zone 1 and 2 load monitoring shackles. Manufactured from Van Beest P-6036 heavy duty bow shackle as standard. Stainless steel or steel load pins available.



Euroload can manufacture using any manufacturer or style of load shackle for specific applications.

At Euroload we calibrate every load shackle in its bow in tension. We never calibrate load shackle pins on V Blocks in compression. The accuracy is unacceptable calibrated on V blocks.

Euroload load shackles have incredible accuracy and repeatability through years of R and D.

These heavy duty load shackles have been designed to cope with any environment with ease.

The options available for the ELT X24 telemetry output are unsurpassed, from battery operated handsets to receiver modules for analogue output, digital output, gateways, datalogging, large digit displays, printers, etc. See our ELT24 Made to Measure brochure for a full list.

The 2.4 GHz signal is worldwide exempt.

The standard range cover 120 tonne to 2000 tonne. Special's are available on request. These load shackles are utilised in varies industries including, Oil and Gas, Manufacturing, Aerospace, renewables, Fishing, Transportation, Marine.

Anywhere a reliable tensile load reading is required within a hazardous zone rated area.

Features:

- . ELT x24 telemetry output. 2.4 GHz worldwide except
- . Unsurpassed range of receivers and modules
- . Free datalogging software
- . High stainless steel load pins
- . Compact size and low headroom.
- . Exceptional heavy duty stainless steel end cap
- . Dual output available both telemetry and cabled
- . IP67 ingress protection as standard
- . Unique removeable electronics to allow removal of battery's within the safe area.
- . Selectable units of measurement
- . Peak hold as standard
- . 2 year manufacturer warranty
- . Worldwide agent network



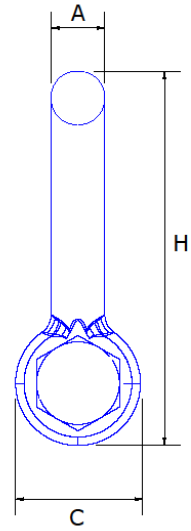
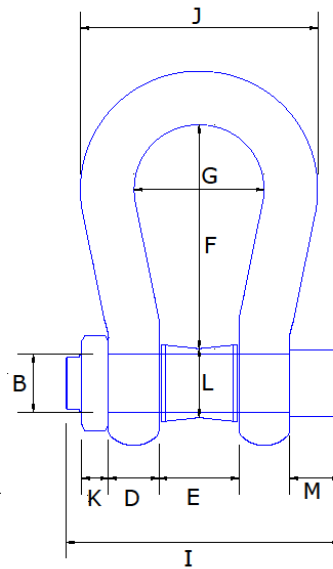

Shackle Dimension`s Van Beest P-6036 Heavy Duty Bow Shackle BN

Shackle Size WLL	a	b	c	d	e	f	g	h	i	j	k	l	m	Weight KG	
120		95	95	208	91	147	359	238	647	440	428	50	180	120	130
150		105	108	238	102	169	380	275	688	490	485	60	190	120	170
200		120	130	279	113	179	479	290	838	520	530	60	200	120	255
250		130	140	299	118	205	510	305	904	560	565	65	210	120	320
300		140	150	325	123	205	576	305	996	575	585	70	236	120	406
400		170	175	376	164	231	613	325	1114	690	665	70	272	120	640
500		180	185	398	164	256	658	350	1190	720	710	70	310	120	755
600		200	205	444	189	282	644	375	1243	810	775	70	360	120	1000
700		210	215	454	204	308	630	400	1263	870	820	70	380	120	1050
800		210	220	464	204	308	620	400	1270	870	820	70	380	120	1170
900		220	230	485	215	328	620	420	1296	920	860	70	390	120	1340
1000		240	240	515	215	349	630	420	1336	940	900	70	400	120	1520
1250		260	270	585	230	369	668	450	1456	1025	970	70	410	120	2070
1500		280	290	625	230	369	718	450	1556	1025	1010	70	420	120	2500
2000		TBC													
Material	Bow and Pin alloy steel, grade 8, quenched and tempered														
Safety Factor	MBL equals 5 x WLL														

Specification`s

Size WLL	120	150	200	250	300	400	500	600	700	800	900	1000	1250	1500	
Units	1 Tonnes 2 Klbs														
Resolution	1 0.01				0.1				2 0.02						
Battery Type	Load Shackle 2 off AA battery's (up to 6 months continuous use) Handset 2 off AA (40 Hours) Battery's must be changed in the safe area.														
Accuracy	±/- 1% of applied load														
Operating temp	-10 deg C to +60 deg C														
Environmental rating	IP67														
Radio Frequency	2.4 GHz ELTX24 transmitter (Ex ib IIC T4 Gb), optional receivers. Transmission range 500 mtr depending on site conditions.														
Handset	As standard ELT-X24 2.4 GHz receiver. (Ex ib IIC T4 Gb)														
Note: Any 2 units of measurement can be specified at time of order.															
Certification package supplied with each link contains: Calibration Certificate to BS 8422:2003, Declaration of Incorporation, EU Declaration of Conformity, Declaration of Manufacture, EC Declaration of Incorporation, CE- Approval Statements, Checklist and user instructions. Material Certificates 2.1, 2.2, 3.1.															
All relevant Hazardous area paperwork and certification															
Note: The electronics have been designed to be removable to allow battery change in the safe area without removing the shackle. The existing load reading is held.															



ELS-X24 Heavy Duty P-6036 Telemetry Load Shackle



Local Agent:

Euroload Limited, Unit 9, Airside Business Park, Dyce Drive, Kirkhill Ind Est, Dyce, Aberdeen, AB21 0GT.
Tel: +44 (0) 1224 774115 e-mail info@euroload.eu