



ELC-333 Low Profile Compression Load Cell.



Euroload Limited low profile pancake load cells have been designed for the harshest of environment's for multiple applications including, silo content's monitoring, hydraulic ram verification, test frames and many more.

Fully stainless-steel construction, output via cable gland or mill-spec connector, IP67 ingress protection, any cable length.

Output options include, Mv/v (standard), 4-20ma, voltage, RS485.

The standard cell is 125 tonne. Special's are available on request. These load links are utilised in varies industries including, Oil and Gas, Manufacturing, Aerospace, Renewables, Fishing, Transportation, Marine. Anywhere a reliable compression load reading is required.

Tailor-made cells can be built to customers specification. Stock held up to 1000 te. Hollow bore, telemetry, low profile version available.



- Features:**
- . Fully stainless steel construction
 - . Cable gland or connector output
 - . Multiple output options available
 - . Multiple readout options available
 - . IP67 ingress protection as standard
 - . Highly accurate and repeatable
 - . Any cable length available at order
 - . 2 year manufacturer warranty
 - . Special design to order available
 - . Massive stock held in factory
 - . Worldwide agent network with stock held



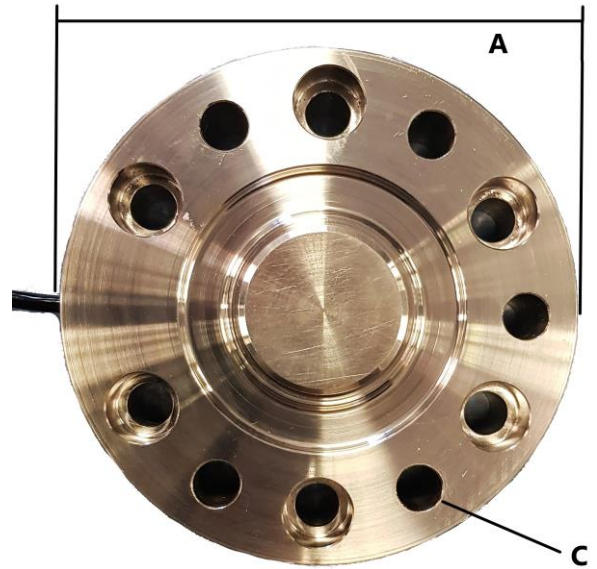
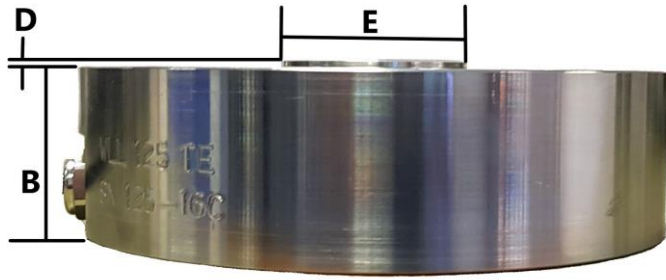

125 Tonne Low Profile Compression Load Cell							
ELC-333		A	B		D	E	
		184	50		3	60	
C		11 off dia 16.5 on 146 PCD on 12 equal spaced pitch as shown.					
125 Tonne Low Profile Compression Load Cell							
Max Load				125 tonne			
Safe Overload				150%			
Ultimate Overload				500%			
Material				17-4 stainless steel			
Output Standard				1.8 Mv/v			
Bridge Resistance				700 ohm			
Accuracy				1% of applied load			
Environmental Rating				IP67			
Insulation Value				Greater than 5 G ohm			
Standard cable length				5 Mtr			
Certification package supplied with each cell contains: Calibration Certificate to BS 8422:2003, Declaration of Incorporation, EU Declaration of Conformity, Declaration of Manufacture Declaration of Incorporation, CE- Approval Statements, Checklist and user instructions. Material Certificates on Request.							



ELC-333 Low Profile Compression Load Cell

Local Agent:

Euroload Limited, Unit 9, Airside Business Park, Dyce Drive, Kirkhill Ind Est, Dyce, Aberdeen, AB21 0GT.
Tel: +44 (0) 1224 774115 e-mail info@euroload.eu